

未注公差/General tolerances(mm)												0.1/10 ±2°	
0 ~ 3	>3 ~ 6	>6 ~ 10	>10 ~ 18	>18 ~ 30	>30 ~ 50	>50 ~ 80	>80 ~ 120	>120 ~ 180	>180 ~ 250	>250 ~ 315	>315 ~ 400		>400 ~ 500
±0.12	±0.18	±0.22	±0.26	±0.31	±0.37	±0.57	±0.80	±0.93	±1.05	±1.15	±1.60	±2.20	±2.50

REV	ECN	DESCRIPTION	DRFT	DATE

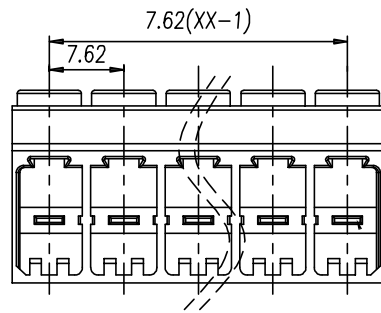
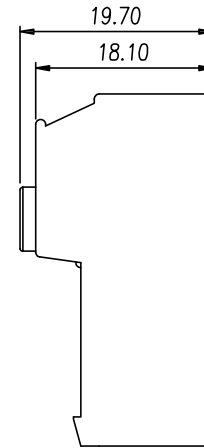
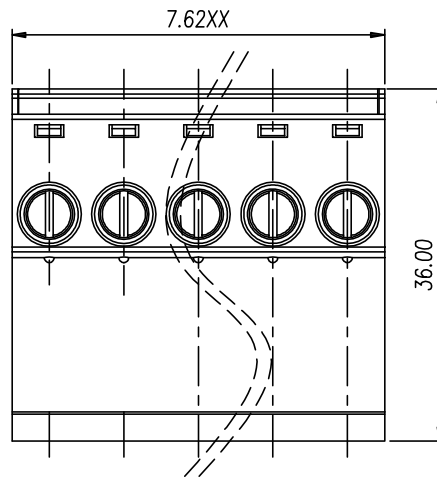

UL 标准/UL Standard:	B	C	D
额定电压/电流/Rated Voltage(V)/Current(A)	600/41	600/41	/
IEC 标准/IEC Standard:			
过压类别/Overvoltage Category/污染等级/Pollution Degree	III/2		
额定电压/电流/Rated Voltage(V)/Current(A)	1000/41		
额定脉冲电压(KV)/Rate Impulse Voltage(KV)	6.0		
螺丝扭矩/Torque Tightening(N·m/Lb.in)	M3/0.5		
线径范围(硬线和软线)/Wire Range(rigid and flexible)(mm ² /AWG)	0.2~6.0/24~8		
间距/Pitch(mm)/线数范围/Poles	7.62/XX=02~12P		
剥线长度/Stripping length(mm)	10		
使用温度范围/Operating temperature(°C)	-40~+105		
符合RoHS环保要求/Conform to RoHS	Yes		

DB3EKR — 7.62 — XXP — C — S/P
 (Series No.) (Pitch) (Poles) Slottef/Phillips
 (Color) : GN:(Green) , BK:(Black) , BU:(Blue) , RD:(Red) , GY:(Gray)
 OG:(Orange) , WT:(White) , YL:(Yellow) , CR:(Clear)

MAT NO.:	/	ORABO 宁波地博电气有限公司 NINGBO DORABO ELECTRICAL CO., LTD	
STATUS:	/	NAME: DB3EKR-7.62-XXP-C-S	
APPD: MARK	2024.10.26	DRAWING NO.:	
CHKD: MARK	2024.10.26	REV	
DRFT: MARK	2024.10.26	MO	
SIZE: A4	mm (inch)	TYPE: CUSTOMER_DRAWING	SCALE: SHEET 1/1